

Downtown Columbia Warfield Neighborhood

Columbia, Maryland

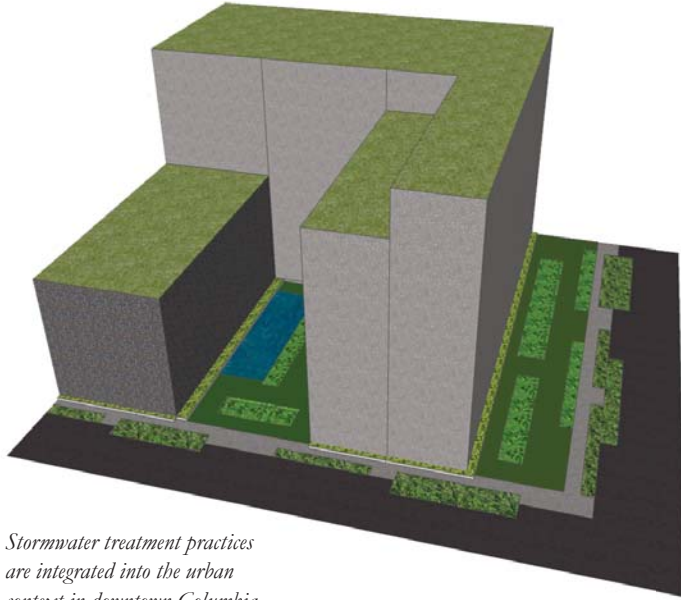

Stormwater treatment practices are integrated into the urban context in downtown Columbia

Downtown Columbia is a mixed use redevelopment plan in the heart of Columbia. The plan converted acres of surface parking lots built prior to stormwater management into five neighborhoods emphasizing multimodal transit integrated with green

The redevelopment plan allows water from more than 50% of the existing impervious cover to be filtered or harvested for reuse, improving water quality and attenuating the flows of the receiving Symphony Stream.

infrastructure. Biohabitats designed the stormwater green infrastructure using environmental site design practices. Portions of the runoff from the first planned building rooftop will be filtered and harvested using subsurface cisterns, while the majority of the rooftop runoff will be treated in micro-bioretenention practices designed into the buildings internal courtyard and external promenade. Meanwhile, tree planters will be installed along the streets and sidewalks to accept roadway runoff. The implementation of this stormwater green infrastructure plan will represent one of the

first case studies whereby environmental site design volumes will be achieved onsite for such dense redevelopment. Biohabitats was also the sustainability consultant for the project and ensured that design guidelines for the Warfield Neighborhood integrated sustainability goals such as reducing heat island effect, enhancing native wildlife habitat and encouraging walkability and bikability.

SERVICES

Planning
Green Infrastructure
Construction Management
Public Outreach
Program Management

*conservation planning
ecological restoration
regenerative design*



800.220.0919

www.biohabitats.com

